

**THE PROJECT**

Washington & Lee's Leyburn Library was the focus of this study. The driving force behind the project was programmatic rather than a need for more collections and readers space. The goal was to transform the existing facility to a 21st-century library — an information commons where students and faculty are provided access to information in all forms and the help required to find and use it.

**CHALLENGE**

Leyburn is on a difficult site. The entrance is off the main campus, set back from the Colonnade. The remaining four library levels follow the steep downward slope of the terrain. The entrance level and floor below are the largest footprints. Because of the site, adding new space on the sides and back of the building is impracticable.

Through a participatory process, functions that should be part of the information commons were identified and include a support desk and offices for reference and technology staff; the reference and microform collections; computer workstations; group study rooms; a multimedia lab; media preview space; digital work space for faculty projects; and smart classrooms. A coffee bar and winter garden were programmed to help in creating an inviting atmosphere. In addition, traditional functions will be located on this level: the circulation and reserve desk, some of the general collections and reader seating, exhibit space, and the administrative offices.

**SOLUTION**

The study solution is a combination of new and renovated space. Additional space can be constructed, toward the Colonnade, at the entrance level and on the floor below. The revitalized main level will support the information commons concept. Two building entrances will be created — one from the front, colonnade side, and the other from the side opposite the existing campus center and on axis with the winter garden. The duel entrance is possible at Washington & Lee due to the success of the honor code and lack of need for one secure entrance.

**RESULTS**

The University is acting on the plan to upgrade Leyburn Library. Implementation will be accomplished in the context of other campus improvements.

\*Project completed under previous name: Dober, Lidsky, Craig and Associates, Inc.

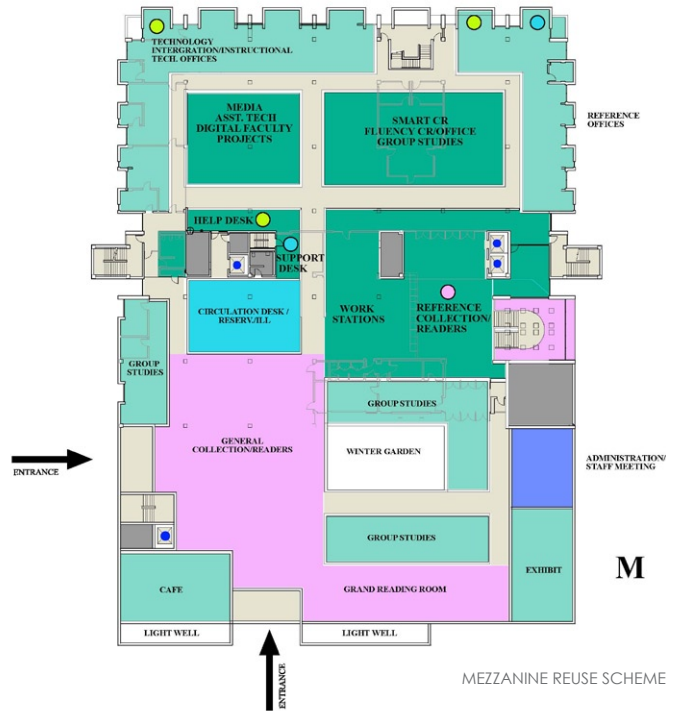

**REFERENCE**

Merrily E. Taylor  
Professor and University Librarian  
540 458 8640

**PRINCIPAL IN-CHARGE**

Arthur J. Lidsky, AICP  
Study Director



**DOBER LIDSKY MATHEY**  
CREATING CAMPUS SOLUTIONS